

WASCOMAT EMERALD WASHERS

Feature-packed for Professional Coin Laundries

Emerald washer's unique vend price wash cycle selection feature is designed to promote coin laundry business automatically any time of day, any day of the week, during slow periods, and more.



Designed and built for the 21st Century!



E620 / 20 lb. cap.
Junior

E630 / 30 lb. cap.
Senior

E640 / 40 lb. cap.
Super Senior

E655 / 55 lb. cap.
Giant

E675 / 75 lb. cap.
Super Giant

Choice of front panel colors: almond, teal green or white; stainless steel option.

Laundry owners and customers love the features and benefits of Emerald washers!

1. Selection of five wash programs, promotional vend prices plus two additional wash programs: "extra extract" and "quick wash" to maximize washer use and income.



2. Unique 4-compartment wash supply dispenser for liquid or powder detergents, bleach and fabric softener for superior wash results.

3. Keypad display counts down the remaining minutes of each wash cycle selected.

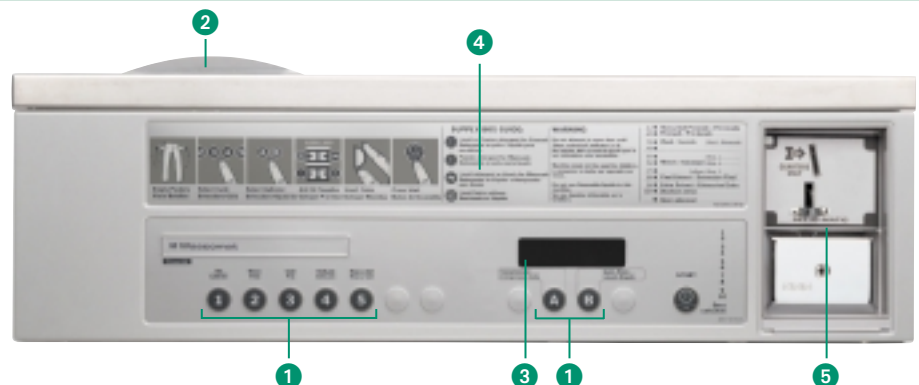

4. Simple, user-friendly instruction panel with universal pictograms and step-by-step directions in English and Spanish.

5. Available with drop coin meter or CashCard system.

Wascomat Laundry Equipment

The Standard of Quality for Over 100 Years!

Technical Specifications

| Model | E620 | | E630 | | E640 | | E655 | | E675 | |
|---|--------------------------------|---------|--------------------------------------|---------|--------------------------------------|---------|--------------------------------------|---------|--------------|---------|
| Capacity (lb/kg) | 20 | 8.5 | 30 | 13 | 40 | 18 | 55 | 25 | 75 | 34 |
| Width (in/mm) | 26 | 660 | 28 3/8 | 720 | 29 1/2 | 750 | 32 11/16 | 830 | 35 13/16 | 910 |
| Depth (overall) (in/mm) | 30 1/8 | 765 | 32 1/2 | 825 | 36 | 915 | 39 | 990 | 42 5/16 | 1075 |
| Height (in/mm) | 43 7/8 | 1115 | 47 1/4 | 1200 | 52 3/16 | 1325 | 55 1/2 | 1410 | 56 7/8 | 1445 |
| Crated width - (in/mm) | 27 3/16 | 690 | 29 1/2 | 750 | 30 11/16 | 780 | 33 7/8 | 860 | 37 | 940 |
| Crated depth - (in/mm) | 32 11/16 | 830 | 35 1/16 | 890 | 39 3/16 | 995 | 43 11/16 | 1110 | 47 1/16 | 1195 |
| Crated height - (in/mm) | 48 | 1219 | 51 5/16 | 1304 | 56 7/16 | 1434 | 61 1/4 | 1556 | 62 7/16 | 1586 |
| Height to bottom of door (in/mm) | 14 | 355 | 14 3/8 | 365 | 17 1/8 | 435 | 19 1/2 | 495 | 19 11/16 | 500 |
| Door opening diameter (in/mm) | 12 3/16 | 310 | 14 3/8 | 365 | 15 9/16 | 395 | 17 1/8 | 435 | 17 1/8 | 435 |
| Cylinder volume (ft ³ /l) | 3.0 | 85 | 4.6 | 130 | 6.4 | 180 | 8.8 | 250 | 11.7 | 330 |
| Cylinder diameter (in/mm) | 20 1/2 | 520 | 23 7/16 | 595 | 25 9/16 | 650 | 28 9/16 | 725 | 31 5/16 | 795 |
| Cylinder depth (in/mm) | 16 5/16 | 414 | 18 7/16 | 468 | 21 5/16 | 542 | 23 7/8 | 606 | 26 3/16 | 665 |
| Drain outlet diameter (in/mm) | 3 | 75 | 3 | 75 | 3 | 75 | 3 | 75 | 3 | 75 |
| Height to centerline of drain (in/mm) | 3 15/16 | 100 | 3 15/16 | 100 | 3 15/16 | 100 | 3 15/16 | 100 | 5 1/2 | 140 |
| Height to electrical connection (in/mm) | 32 1/2 | 825 | 35 13/16 | 910 | 40 3/4 | 1035 | 44 1/8 | 1120 | 45 1/2 | 1155 |
| Water connections (in/mm) (approx) | 40 9/16 | 1030 | 43 7/8 | 1115 | 49 | 1245 | 52 3/8 | 1330 | 53 3/4 | 1365 |
| Dynamic load (lb/kN) | +/-670 | +/-3.1 | +/-922 | +/-4.1 | +/-1192 | +/-5.3 | +/-1259 | +/-5.6 | +/-1320 | +/-5.9 |
| Dynamic frequency (Hz) | 8.8 | | 8.2 | | 7.9 | | 7.4 | | 7.9 | |
| Noise level (dBA) | 66 | | 68 | | 80 | | 80 | | 80 | |
| Net wt (lb/kg) | 300 | 136 | 386 | 175 | 503 | 228 | 633 | 287 | 838 | 380 |
| Crated weight (lb/kg) | 331 | 150 | 419 | 190 | 540 | 245 | 672 | 305 | 882 | 400 |
| Operating Speeds | | | | | | | | | | |
| Wash (rpm) | 52 | | 49 | | 44 | | 44 | | 42 | |
| Extract (rpm/G-Force) | 528 / 81 | | 494 / 81 | | 471 / 81 | | 446 / 81 | | 410/81 | |
| Electrical Requirements (standard) | | | | | | | | | | |
| Voltage/frequency/phase | 208-240/60/3 | | 208-240/60/3 | | 208-240/60/3 | | 208-240/60/3 | | 208-240/60/3 | |
| Full-load current (Amps) / Ckt breaker (Amps) | 4.0 / 15 | | 5.8 / 15 | | 7.4 / 15 | | 9.2 / 15 | | 10.8 / 15 | |
| Motor output - wash (hp/kW) | 0.2 / 0.13 | | 0.3 / 0.2 | | 0.4 / 0.3 | | 0.5 / 0.4 | | 0.7 / 0.5 | |
| Motor output - extract (hp/kW) | 1.0 / 0.75 | | 1.5 / 1.1 | | 1.8 / 1.3 | | 2.7 / 2.0 | | 3.5 / 2.6 | |
| Alternate Voltages | | | | | | | | | | |
| Voltage/frequency/phase-breaker rating | 120/60 (15A) 440/60/3 (10A) | | 208-240/60/1 (15A) 440/60/3 (10A) | | 208-240/60/1 (25A) 440/60/3 (10A) | | 208-240/60/1 (30A) 440/60/3 (10A) | | - | |
| Water information | | | | | | | | | | |
| Inlet fittings (* = 2 cold inlets) | DN20 | 3/4 | DN20 | 3/4 | DN20* | 3/4* | DN20* | 3/4* | DN20* | 3/4* |
| Flow (gpm/lpm @ 45 psi) (each inlet) | 5 | 20 | 5 | 20 | 5 | 20 | 16 | 60 | 16 | 60 |
| Recommended water pressure (psi/kPa) | 30-90 | 200-600 | 30-90 | 200-600 | 30-90 | 200-600 | 30-90 | 200-600 | 30-90 | 200-600 |

Features and Benefits

- Three-inch, front-mounted water-operated drain valve reduces clogs and is easy to clean.
- Unique wire harnesses with foolproof “quick disconnect” plugs simplify service.
- Hot, cold, warm, delicate and heavy soil wash cycle options to reduce time, water, and energy consumption.
- Unibody construction eliminates welds for superior strength, reliability, and durability.
- Single motor drive.
- Rigid cast back gable and bearing housing for long machine life.
- Durable door lock system unlocks at the end of wash cycle.
- Interchangeable parts from one size and model washer to another.

Refer installation and servicing to qualified, licensed personnel. Always read installation and operating manuals and consult local codes before installation. Protect machines with properly rated, inverse-time, common-trip, industrial-type circuit breakers ONLY. Warranty void if not properly installed. Solid-mount machines require a custom concrete foundation, and are not suitable for upper-floor or above-basement installations. Contact Wascomat for more information and for availability of machines for electric services not listed. Specifications subject to change without notice. Wascomat assumes no responsibility for errors or omissions in this information.



For more information on the full line of Wascomat washers, dryers and low-cost financing, call Wascomat toll free today.

Wascomat Laundry Equipment

1-800-645-2204 • www.wascomat.com

461 Doughty Blvd., Inwood, L.I., N.Y. 11096-0338
 Sales and Administration – Tel: 516-371-4400 • Fax: 516-371-4204 • e-mail: sales@wascomat.com
 Spare Parts – Tel: 516-371-2000 • Fax: 516-371-4029 • e-mail: parts@wascomat.com
 Technical Support – Tel: 516-371-0700 • Fax: 516-371-4029
 En Mexico: Llame gratis a este numero 001-800-010-1010



Your local independent authorized dealer

